

Typical Window Head - Brick Mold

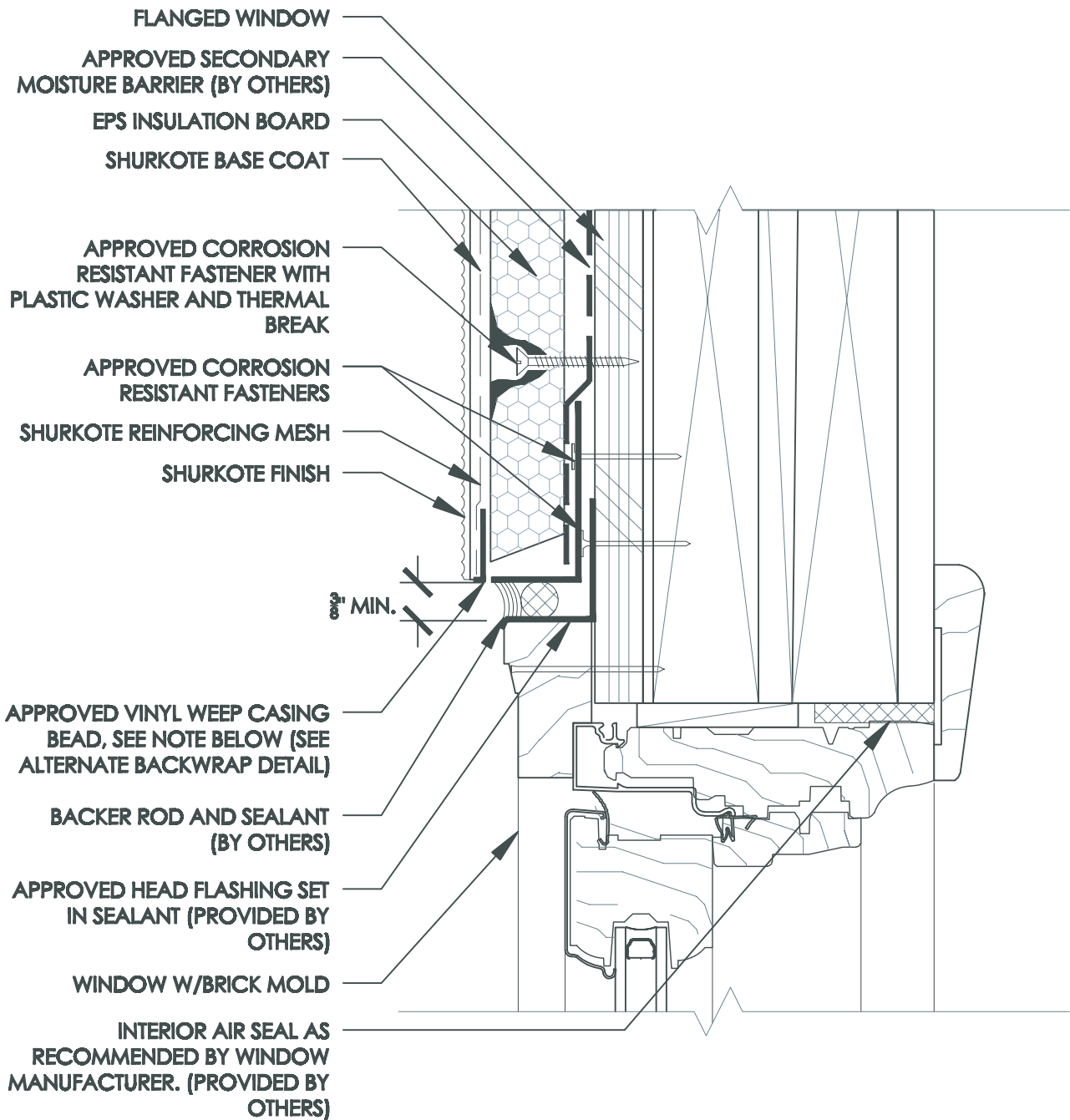

NOTE: MAINTAIN $\frac{3}{8}$ " SPACE BETWEEN BEVELED INSULATION AND WEEP CASING BEAD

September 2009



UltraKote Products, Inc.
 327 South 27th Avenue
 Phoenix, Arizona 85009
 Phone: 800.224.2344
 Fax: 602.272.6445
 www.ultrakoteproducts.com